



Installation Guide, MPower Echelon Console

AC™ Performance, AC™ Sport and AC™ Performance Plus

Schwinn Echelon Console (External Routing)

1. Install batteries to console. Mount the console to the bike.

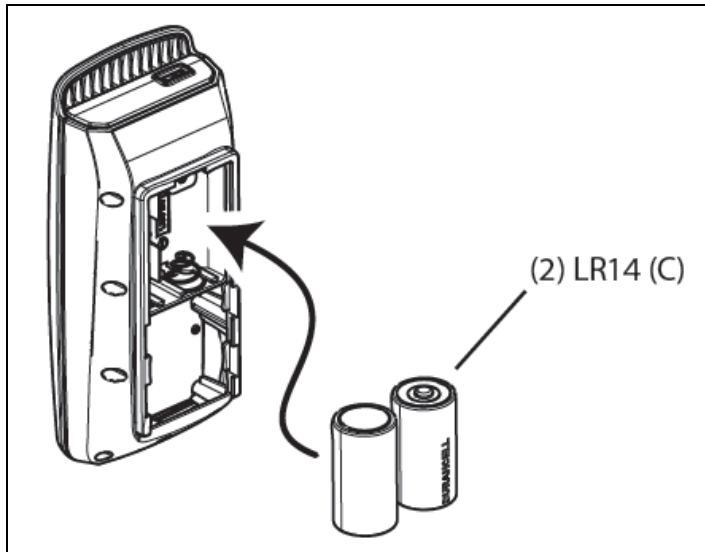

2. Mount the console bracket using the screws that are appropriate for the bike that the console is being installed on.

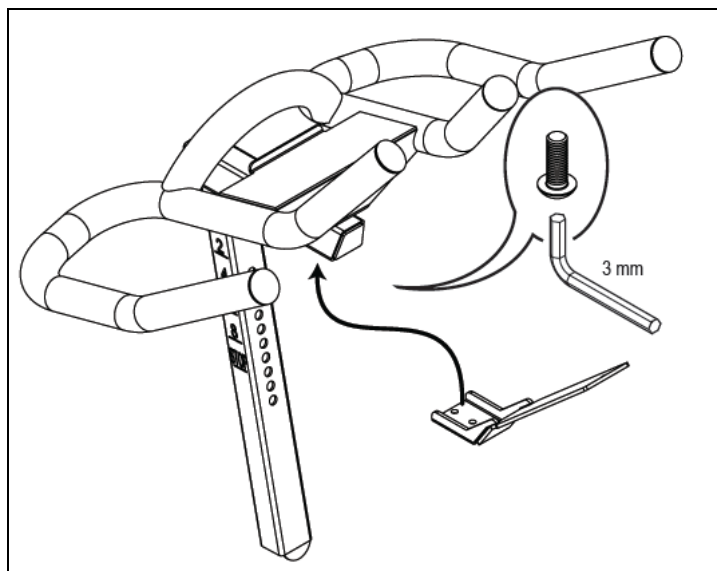

ACP/ACS

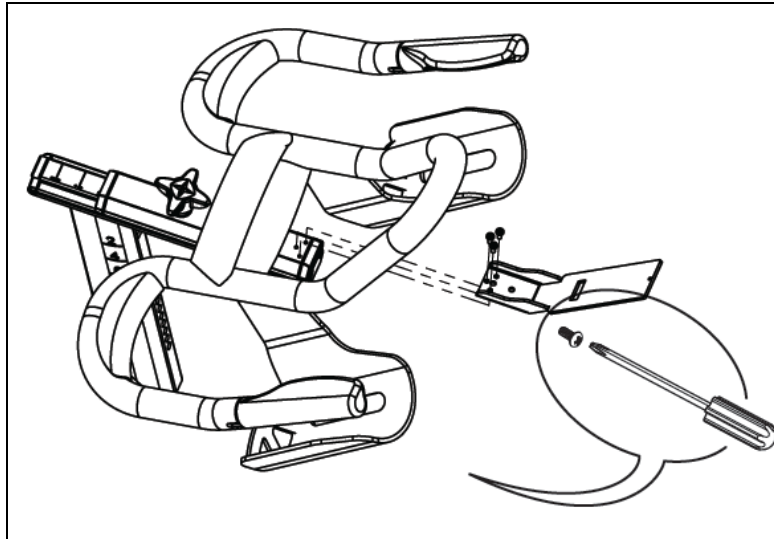

ACPP

3. Mount console to the bracket and use the screw to fasten in place.

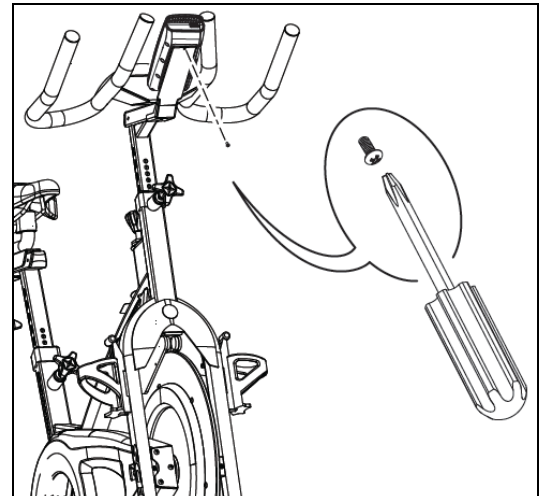
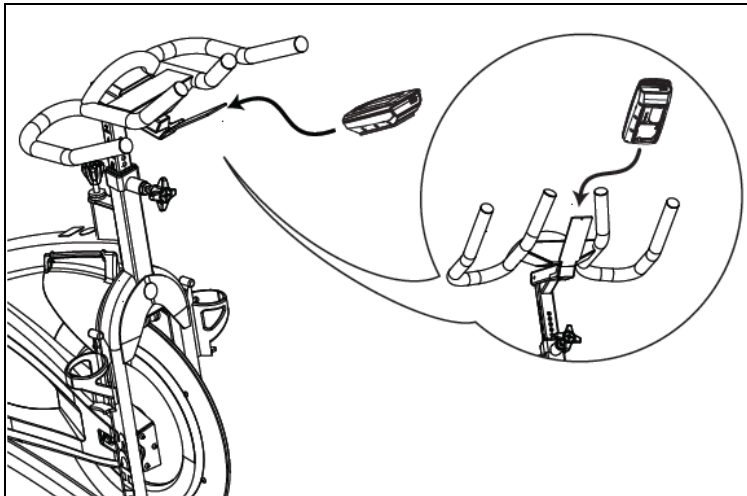

AC™ Performance, AC™ Performance Plus and AC™ Sport



Install the Cable Duct and Cable

1. Prior to installing the upper conduit, clean tube with mixture of water and isopropyl alcohol. Dry surface with the towel or air dry.
2. Slide the cable duct cover onto the base, winged taps on the upper side (detail A below)
3. Peel off backing adhesive and align duct part number 020-0048 to forward edge and lower edge of the frame tube (as shown). Apply normal pressure for 5 seconds

Note: It is recommended that the duct set for 24 hours before use

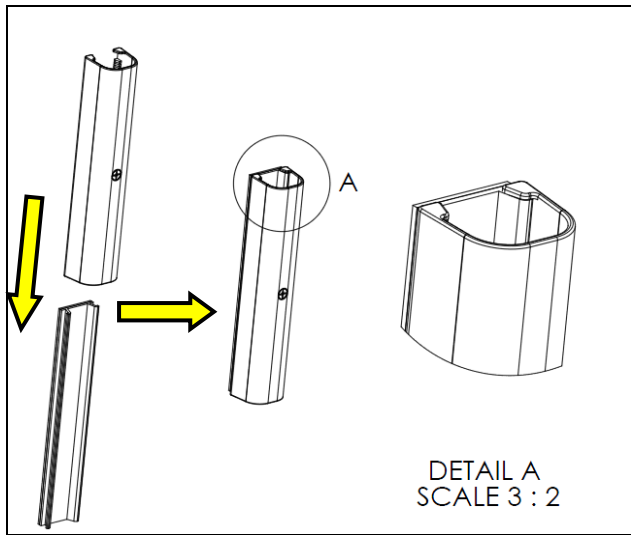

Cable duct assy (020-0048)

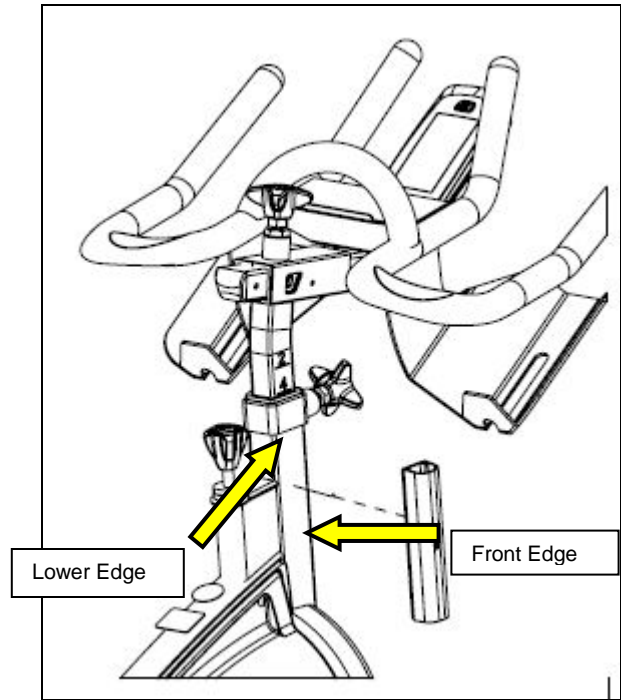

ACS shown, ACP and ACPP similar



Customer Service Bulletin

4. Slide handle bar to forward position.
5. Wrap 1 cable clamp around the harness cable and mount it to the bottom of the handle bar using the existing screw.

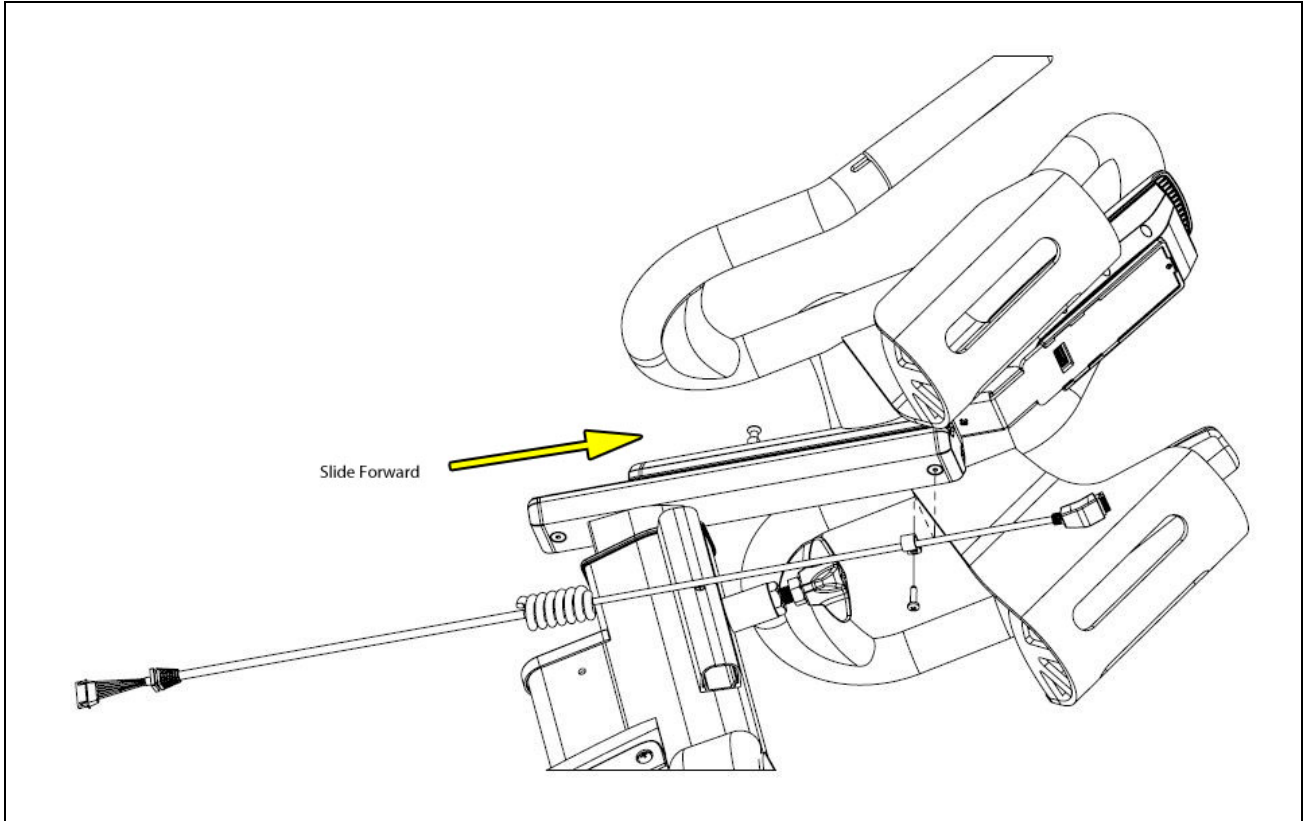

AC™ Performance Plus shown



6. Insert the harness cable through the slot as shown in the diagram.

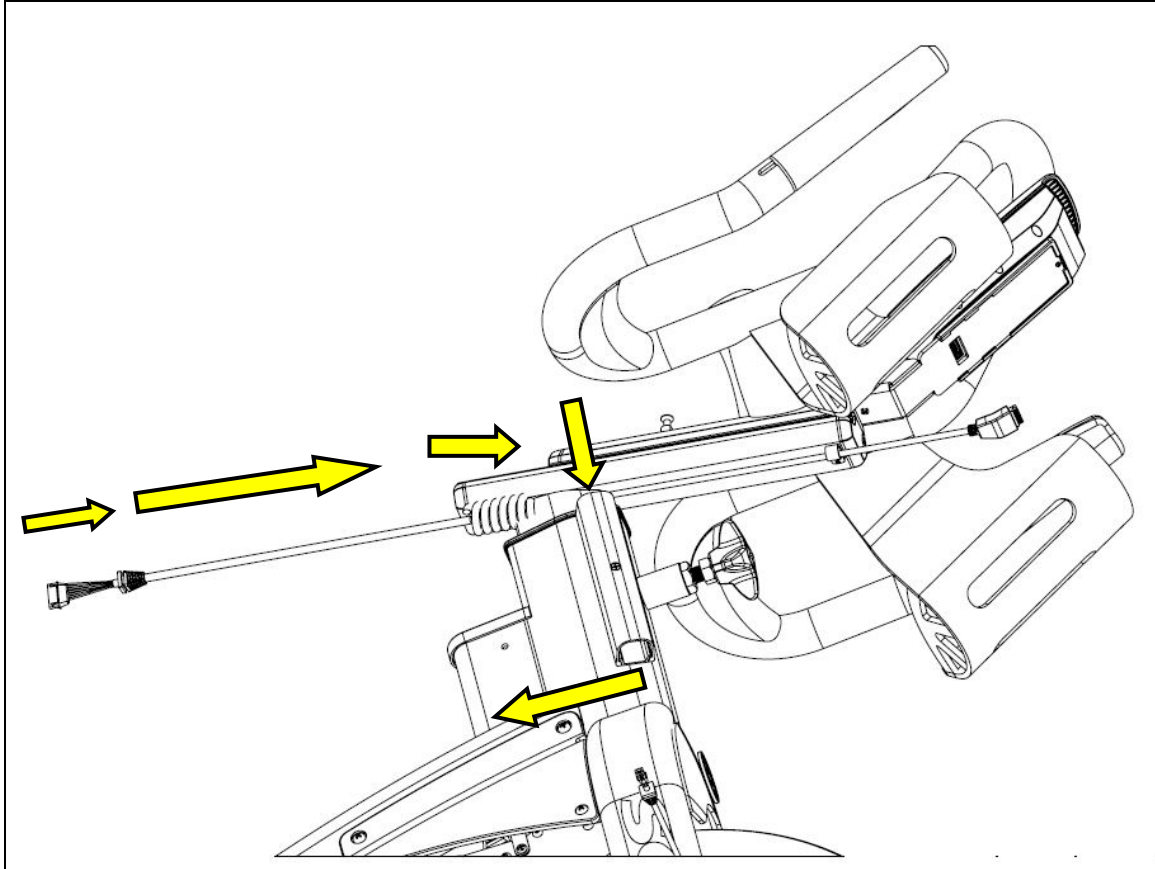

AC™ Performance Plus shown



Customer Service Bulletin

- Using a phillips screw driver, remove the sweat guard (Do not use a power drill in removing and re-installing)

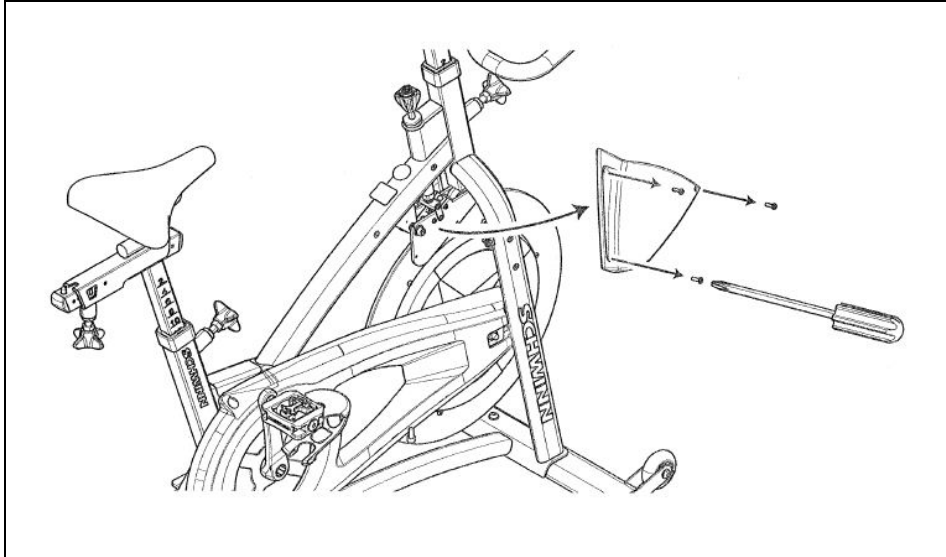

- For AC™ Performance Plus Only: Trim off upper corner rubber piece as shown to allow the wire to pass through.



AC Performance Plus



Customer Service Bulletin

9. Plug the console cable to the power sensor port (7pin) and the speed sensor cable to speed sensor port (2pin).

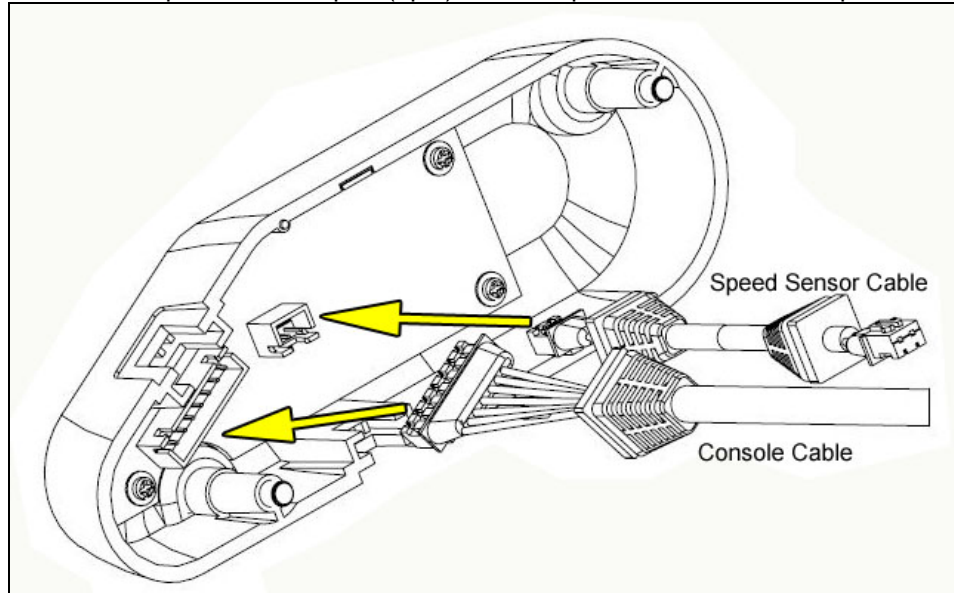

Align and push the square rubber grommets into the appropriate slots as shown below

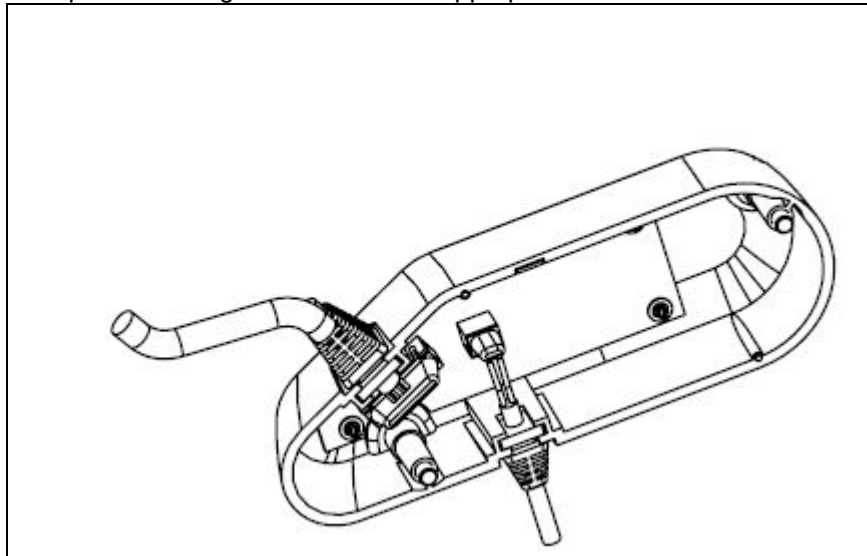



10. Mount the power sensor to the brake carriage. Include the rubber gasket.

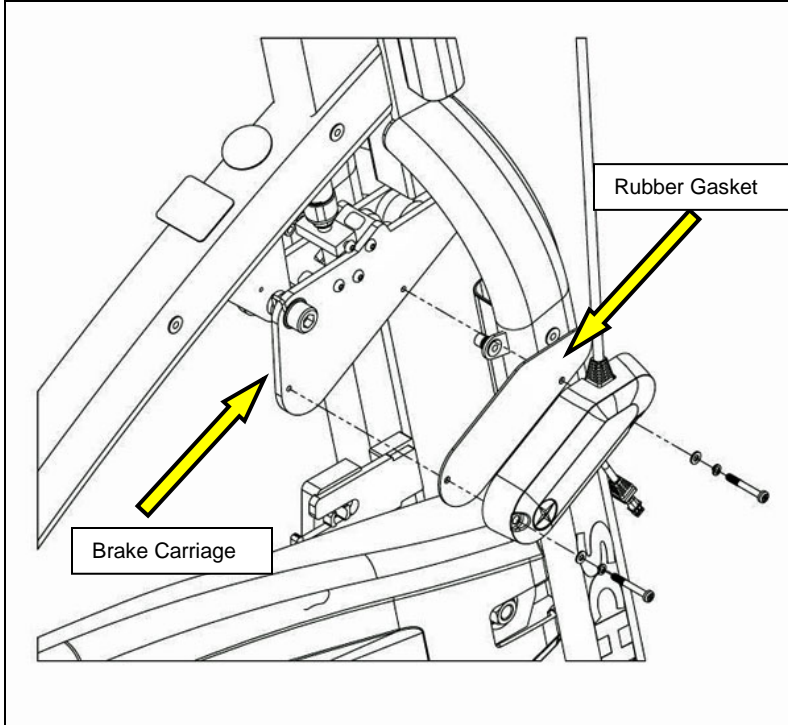

11. Re-mount the sweat guard.

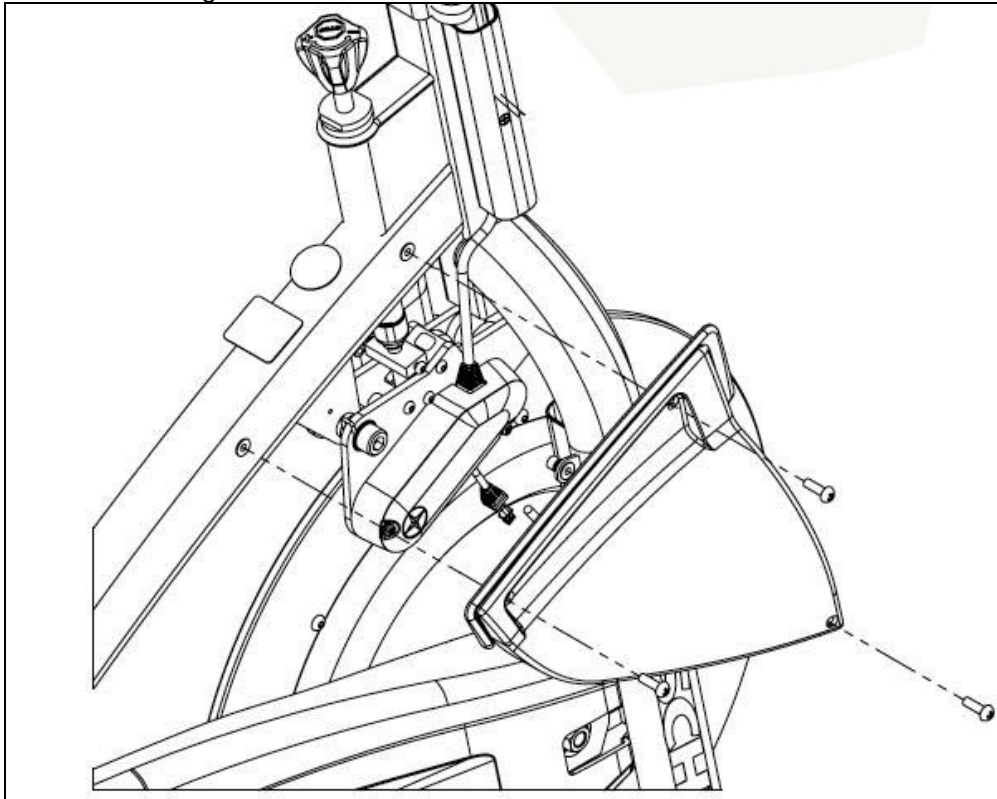



12. Loosen the top screw (Do not use a power drill)
13. Push brake knob all the way down, and then tighten screw.

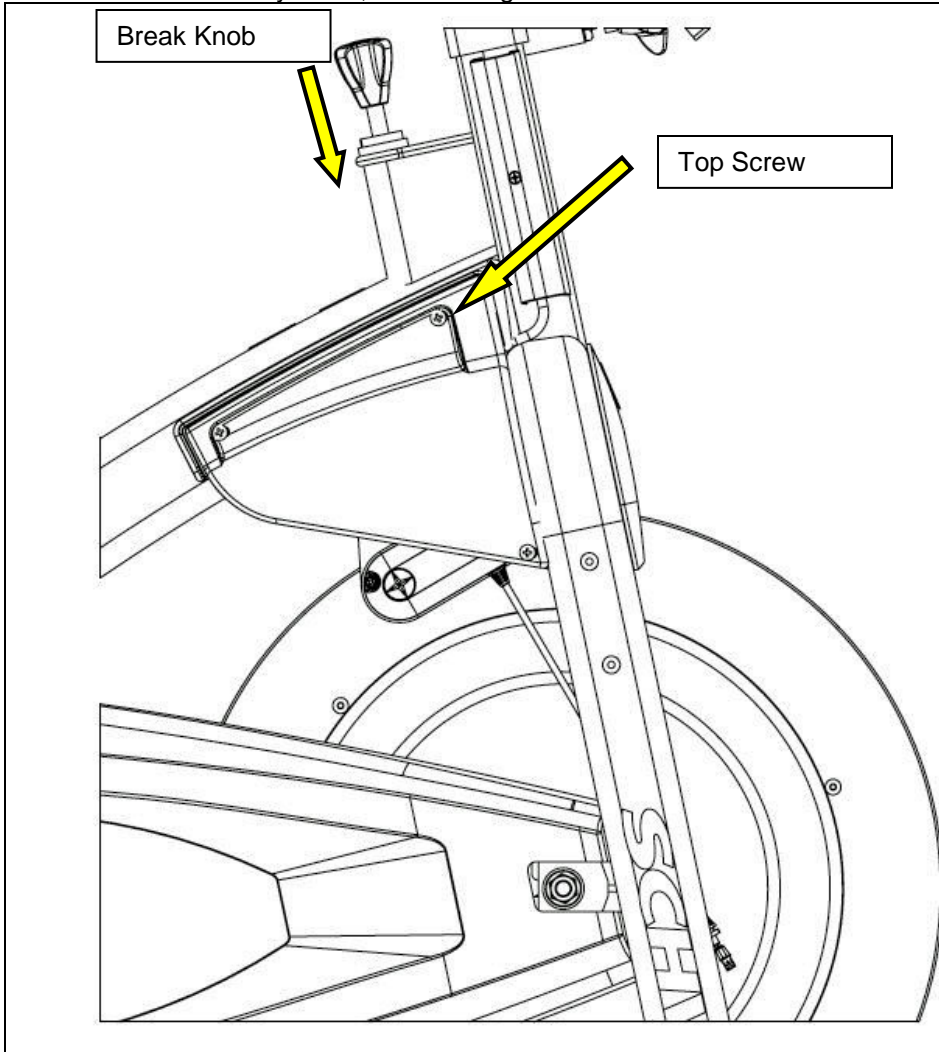



Customer Service Bulletin

14. Prior to applying the lower conduit, clean the surface of the inner right fork with alcohol and clean cloth. Slide the cover into the base as necessary then peel off the non stick strip off the wire conduit. Place it firmly on the inside of the right hand fork.

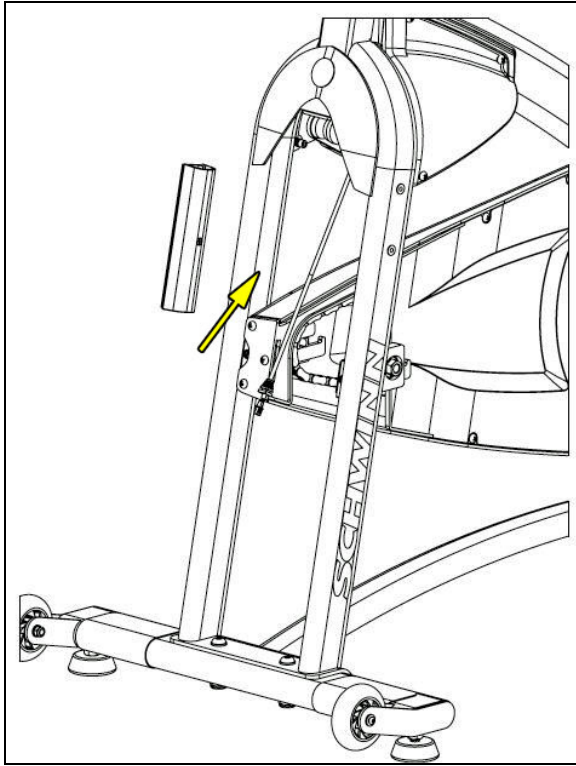

There should be about one inch gap between chain guard/rpm sensor bracket and the wire conduit.

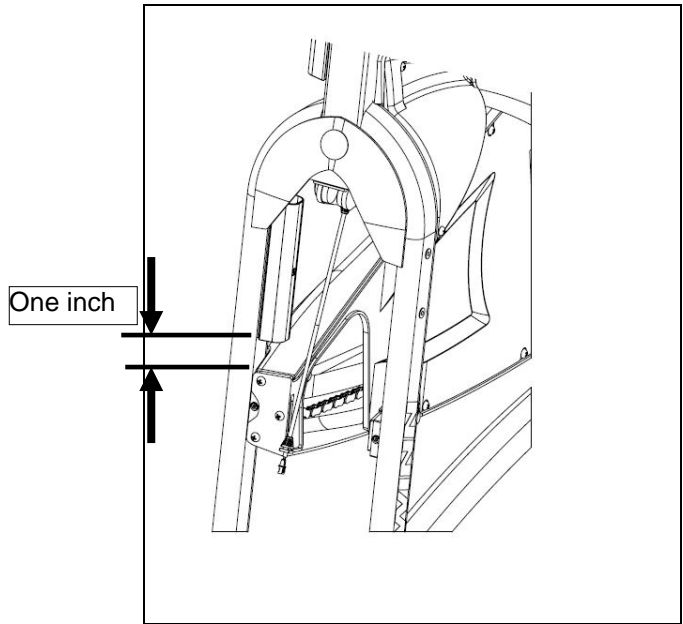

15. Insert the cadence “RPM” sensor wire into the RPM sensor.

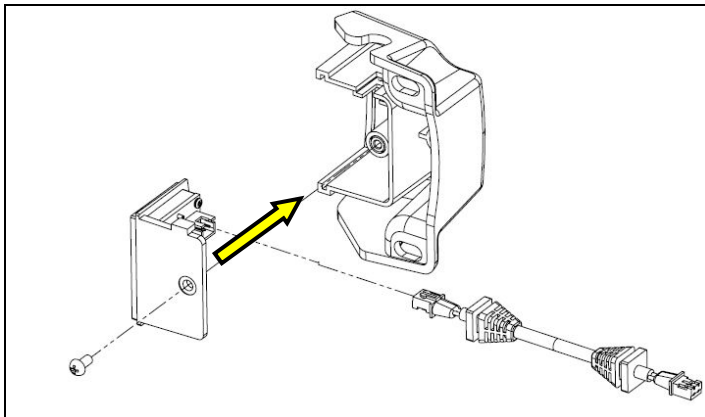

- A.C.™ Performance Plus shown
- A.C.™ Performance and AC Sport use adaptor plate

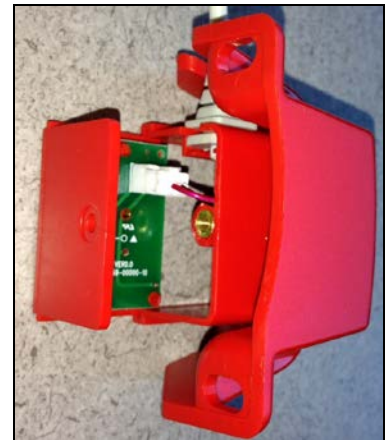

Speed Sensor



Customer Service Bulletin

16. Mount the RPM sensor onto the chain-guard using the screw. Place 2 #8 finishing washers in between the chain guard and RPM sensor as shown. Make sure the gap is 5mm or less between the RPM sensor housing and the flywheel.

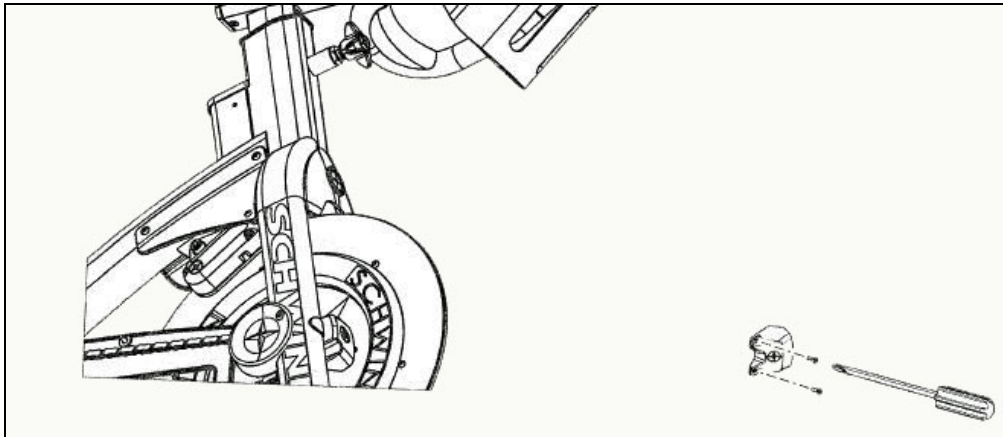
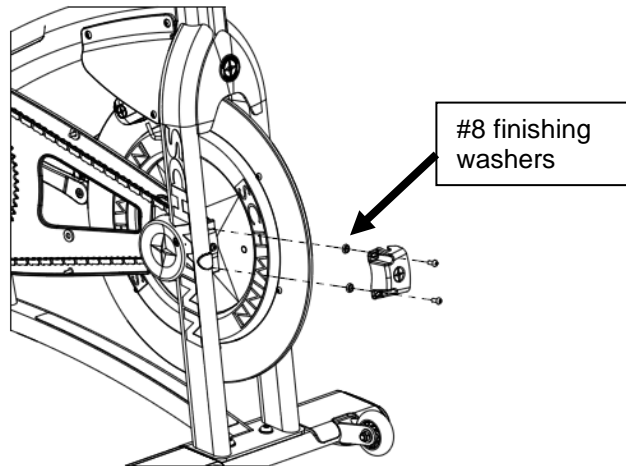

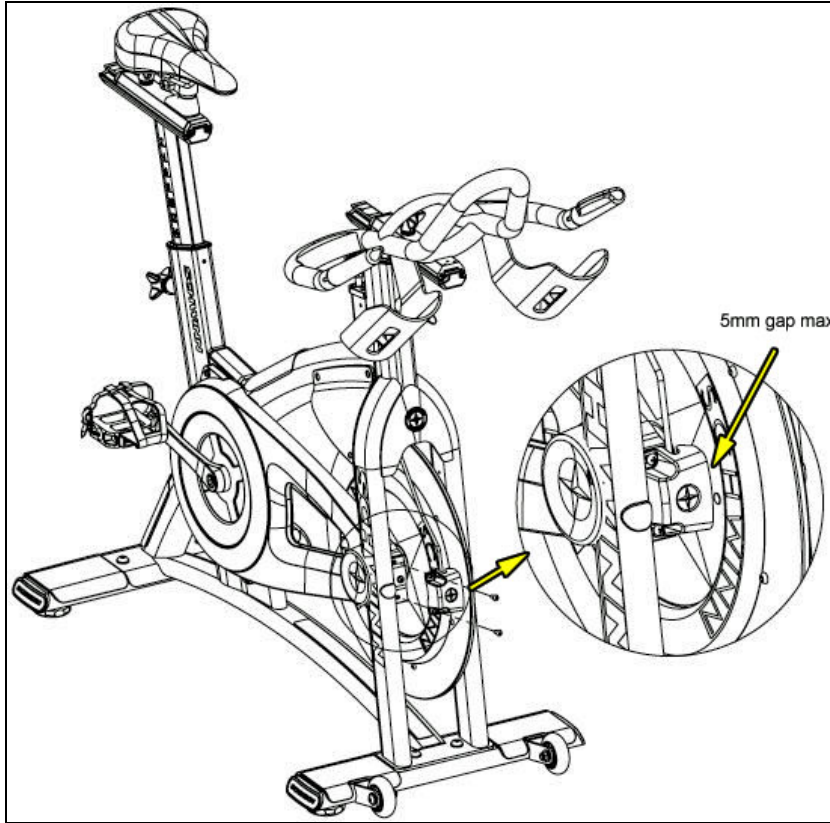



Schwinn® Echelon™ console (Internal routing)

1. Insert batteries into console and refer to the manual

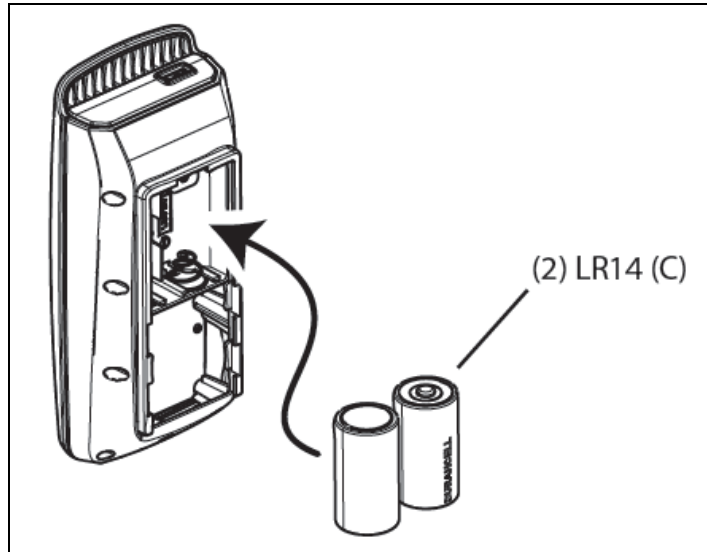

2. To mount the supporting bracket, screw on to the handlebar

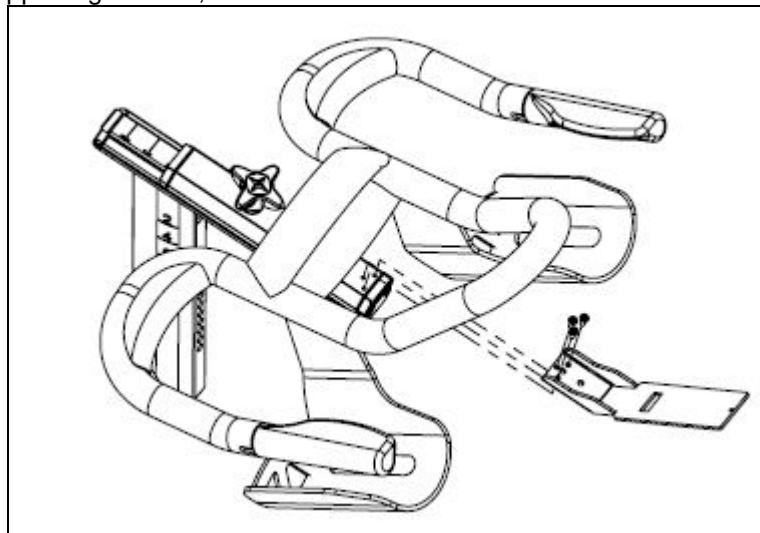



3. Mount the console to the handlebar bracket.

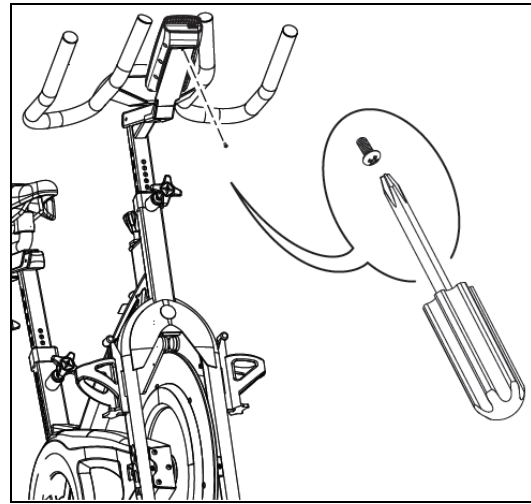
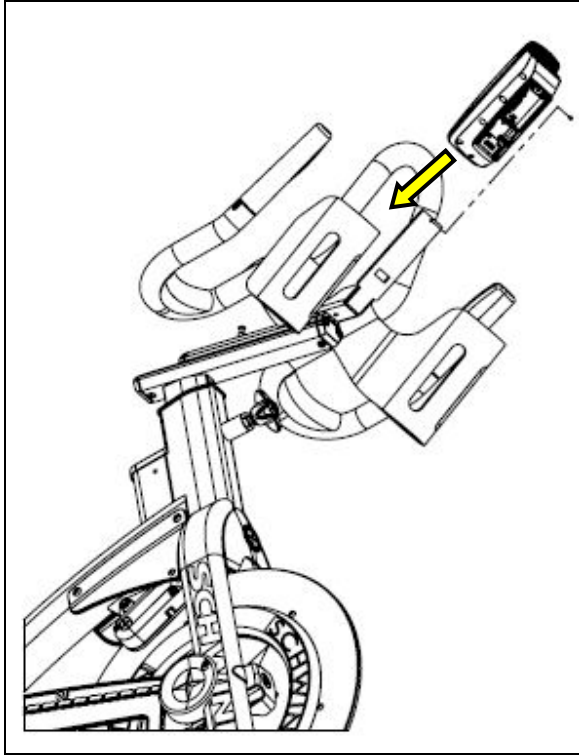

4. Mount the cable clip beneath the handlebar slider using the existing screw.

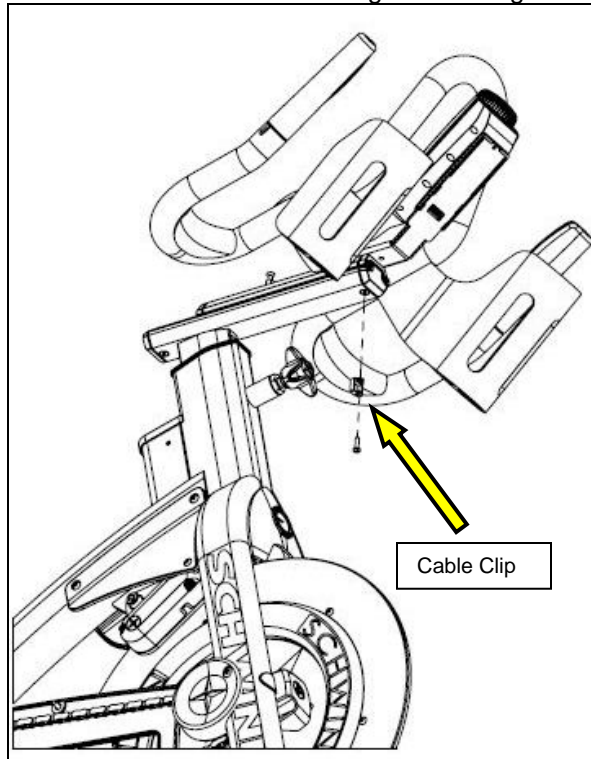



5. - Pull handle bar up to highest position
- Route 2-pin cable through the opening (for bikes with power sensor upgrade, use the 7-pin cable)
- Snap the cable into the cable clip

Tip: Attaching a metal wire to the end of the cable plug will help pulling the cable though the opening.

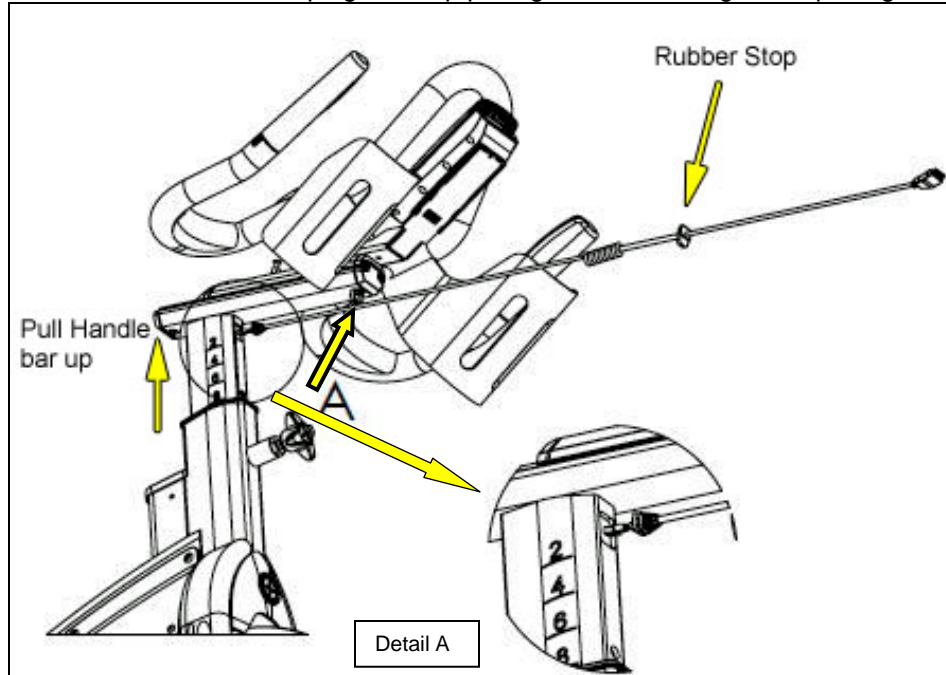



Customer Service Bulletin

6. Push cable through hole until the rubber stop snaps and locks into position.
(Align the rubber stop smaller tap at the bottom, then push the top into place, as shown in detail A below)

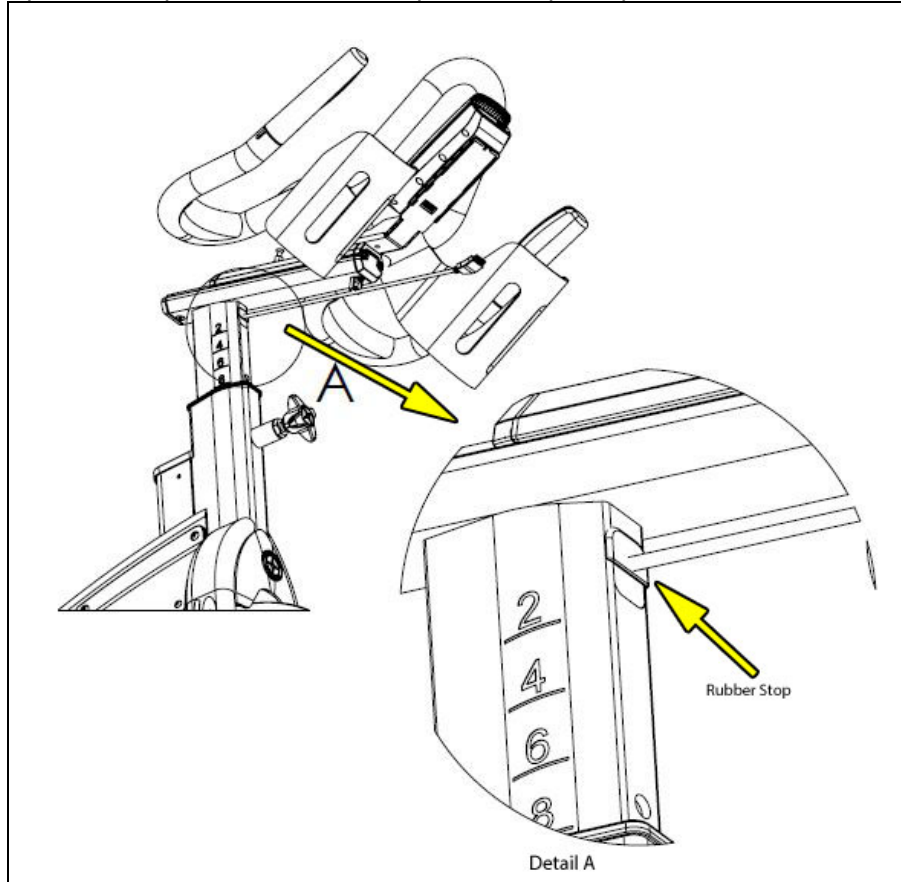



7. Remove the RH sweat guard by screwdriver (NO power drills in removing or re-installing)

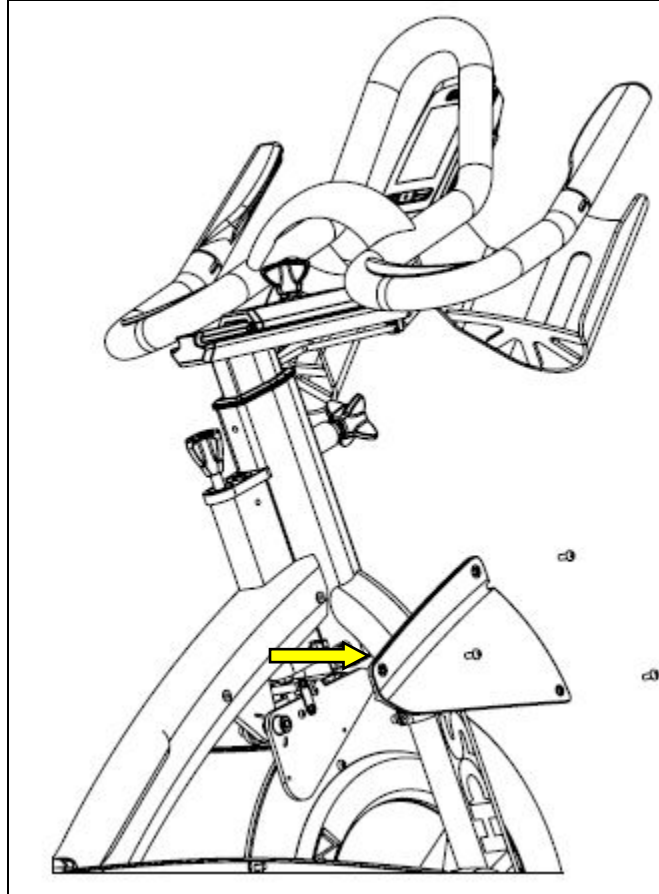



Customer Service Bulletin

8. Adjust the handle bar down until the cable plug is seen through the “cutout” in the frame.
 - Pull the cable out from the cutout.

- Tip:
- Use a pair of long nose pliers
 - If you attached a metal wire to the cable end (step 5). It is easier to pull the cable out from the frame “cutout”.

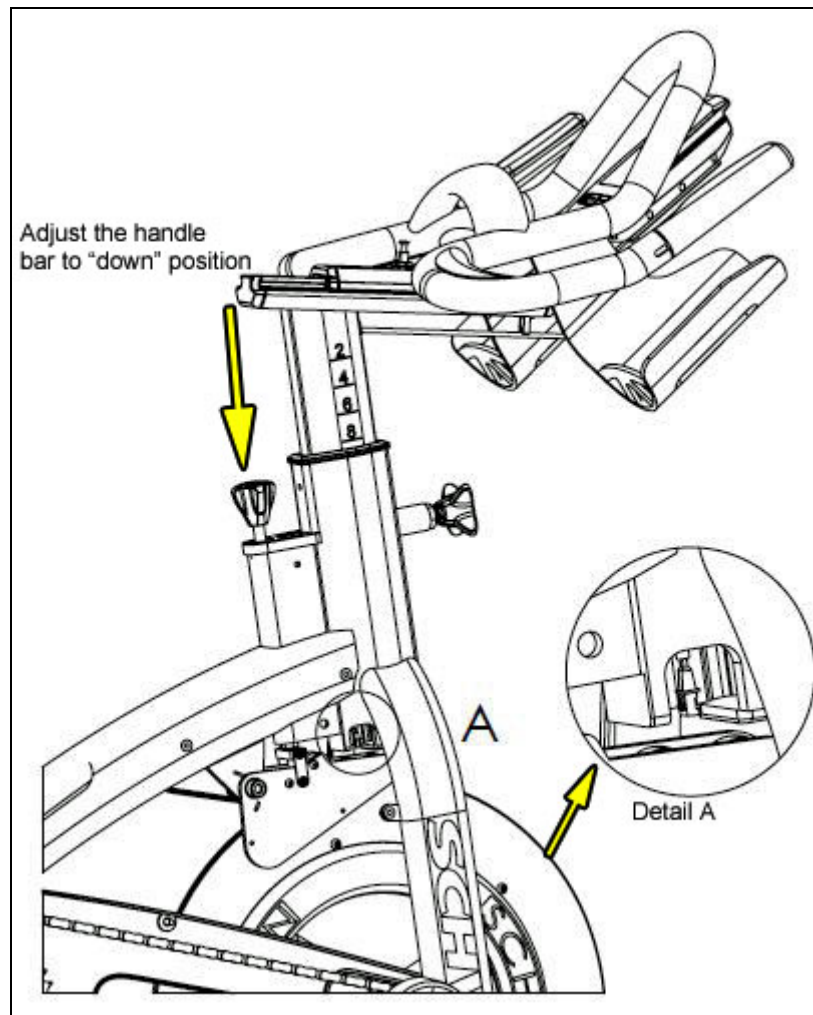



- For power sensor upgrade only (skip this step for bikes without power sensor)
- Install power sensor following steps 8 thru 10 (external routing).

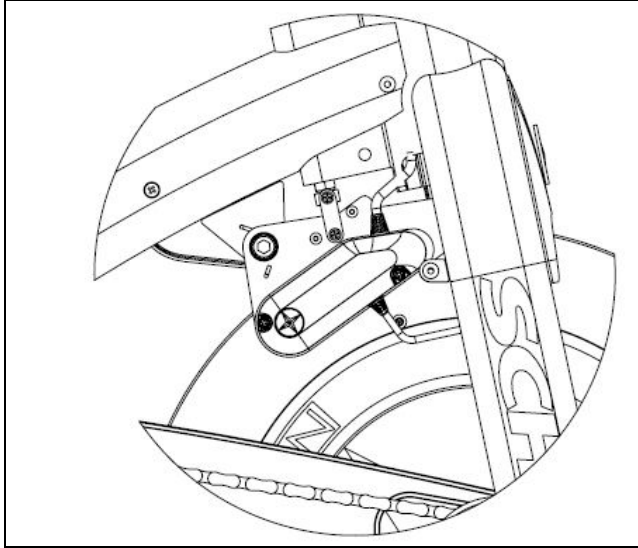



Customer Service Bulletin

9. Insert the two cable clamps to the two holes on the inside of the RH fork. Push the rivets into lock.

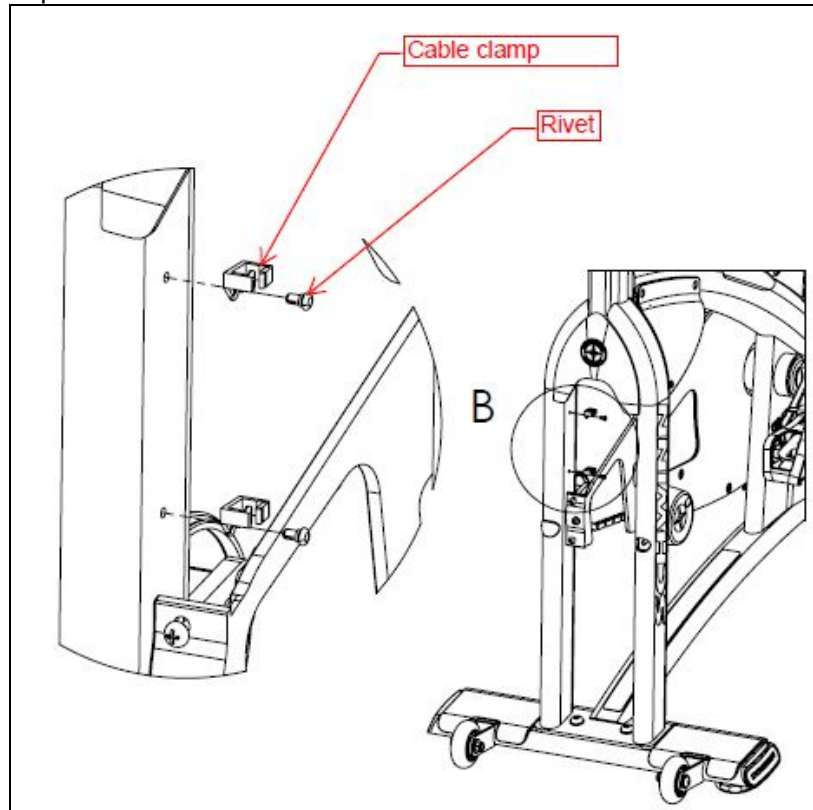

10. Route the RPM sensor cable from the power sensor through the saddle straps on the right leg to the RPM sensor.
Note: Be sure to tightly strap the cable inside/around the saddle clamps, do not let the cable come in close contact with the flywheel. Excessive looseness/slack in cable may affect flywheel performance.

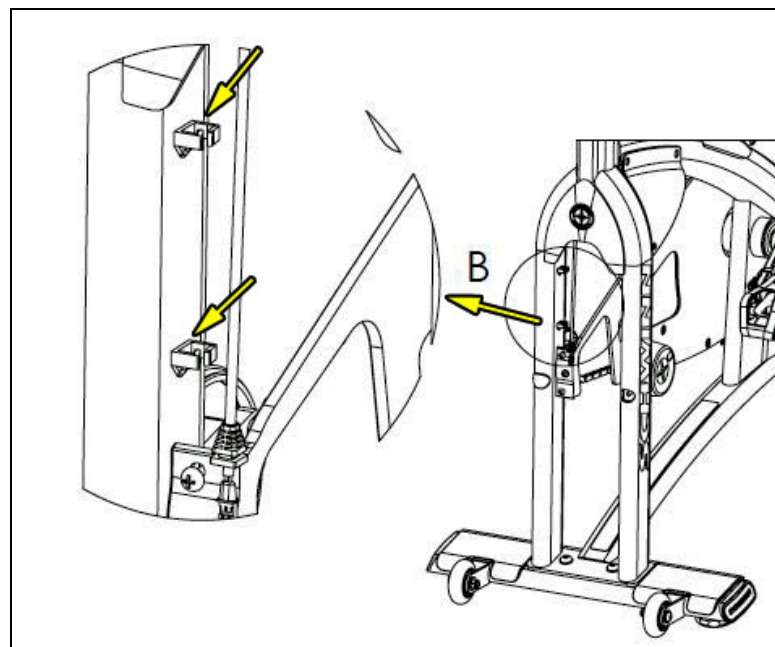



11. Connect the RPM sensor cable to the RPM sensor (cadence sensor).

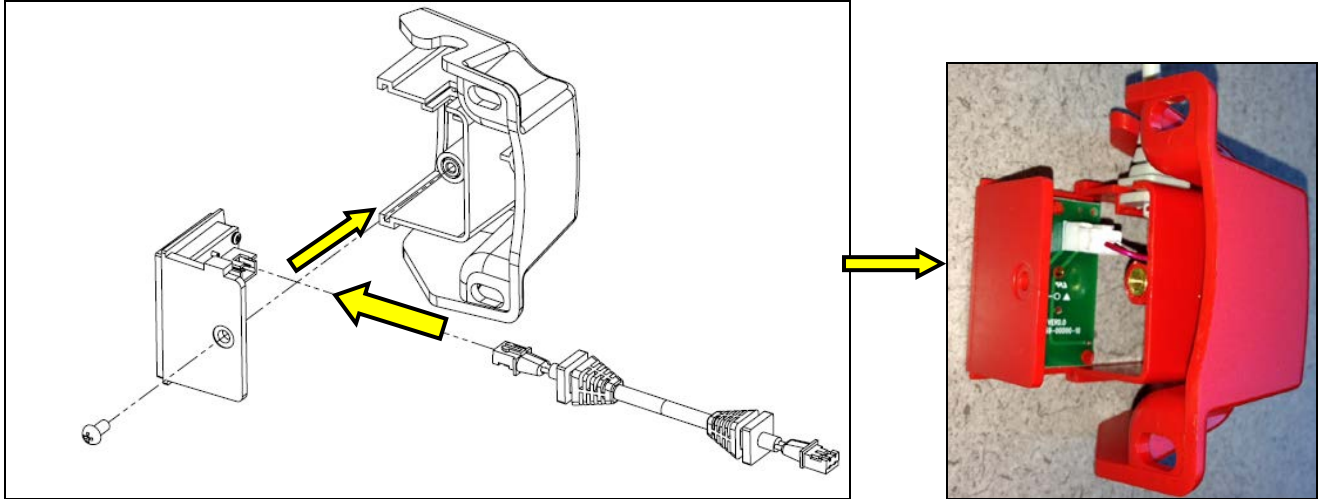

12. Mount the RPM sensor onto the chain guard. Make sure the gap is 5mm or less between the RPM sensor housing and the flywheel.

