

CFF FLAT UTILITY BENCH

Assembly & Care Instructions



THANK YOU!

First of all, thank you for purchasing the CFF Flat Utility Bench (CFF-FB). With its 700lb capacity and warranty (frame: lifetime, pad: 1-yr), this flat utility bench is flat-out ready for action. Please review these instructions to ensure your bench is correctly assembled and lasts.

INCLUDED IN THIS DOCUMENT

- exploded drawing & parts list
- assembly steps
- caring for your bench

EXPLODED DRAWING & PARTS LIST

PLEASE MAKE SURE YOU HAVE ALL THE PIECES!

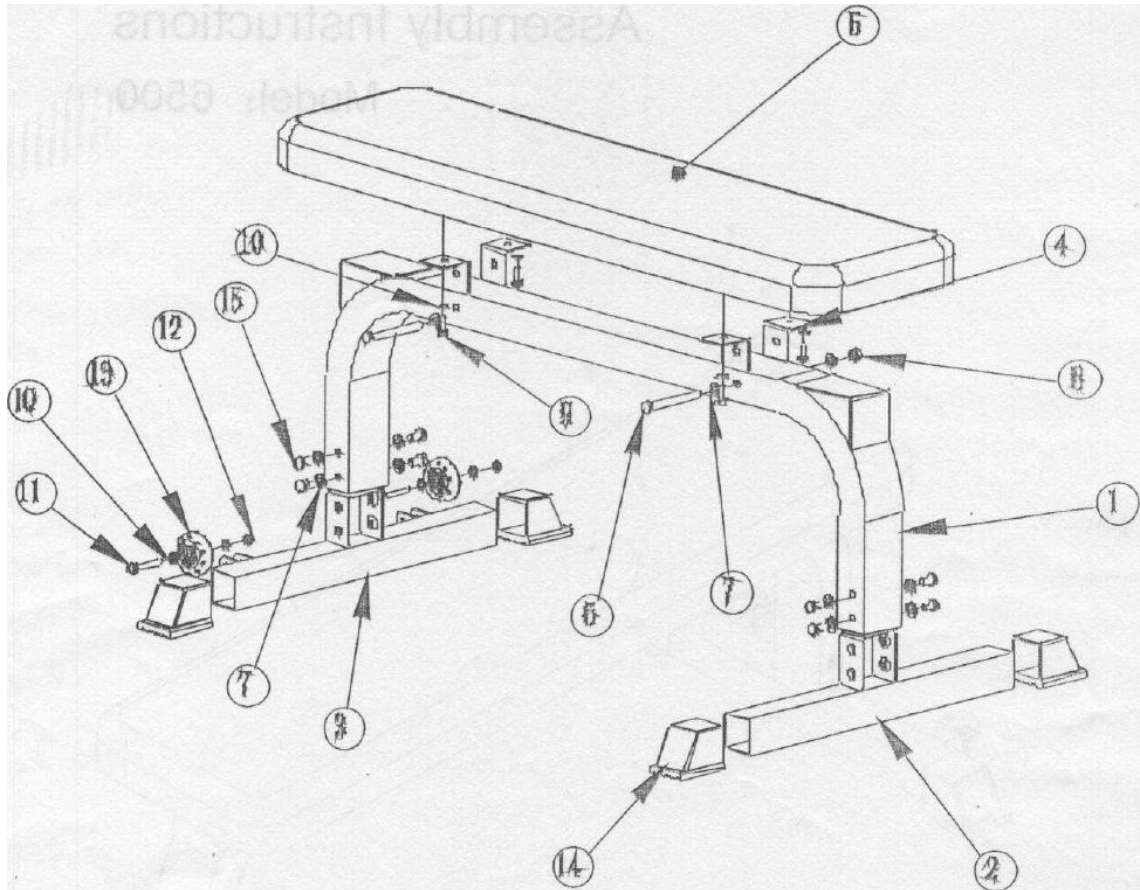

No.	Description	Qty
1	Main Frame	1
2	Front Base Frame	1
3	Rear Base Frame	1
4	Connect Bracket	4
5	Back Pad	1
6	Hex Bolt, M10x95mm	2
7	Flat Washer for M10 Bolt	12
8	Lock Nut for M10 Bolt	2
9	Hex Bolt, M8x25mm	2
10	Flat Washer for M8 Bolt	8
11	Hex Bolt, M8x40mm	2
12	M8 Lock Nut	2
13	Transportation Wheel	2
14	End Cap	4
15	Hex Bolt, M10x20mm	8

ASSEMBLY STEPS

STEP 1

Attach main frame [1] to front & rear base frames [2, 3] using (8) hex bolts & washers [15, 7].

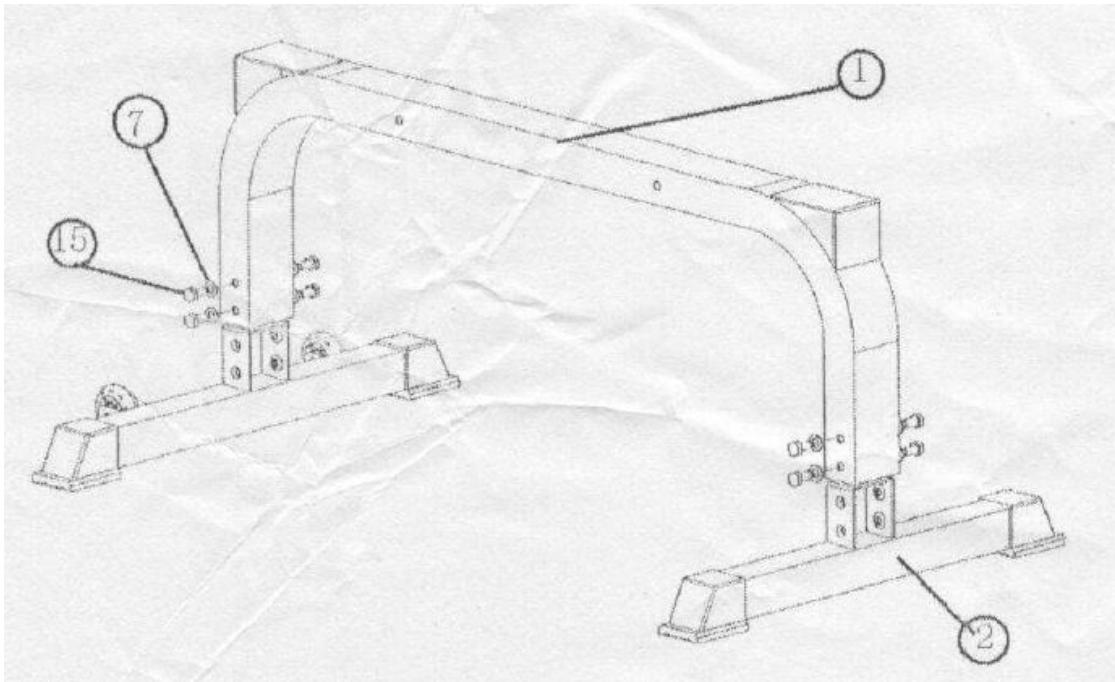

STEP 2

Install brackets [4] to main frame [1] using (4) hex bolts & washers [6, 7], & (2) lock nuts [8].

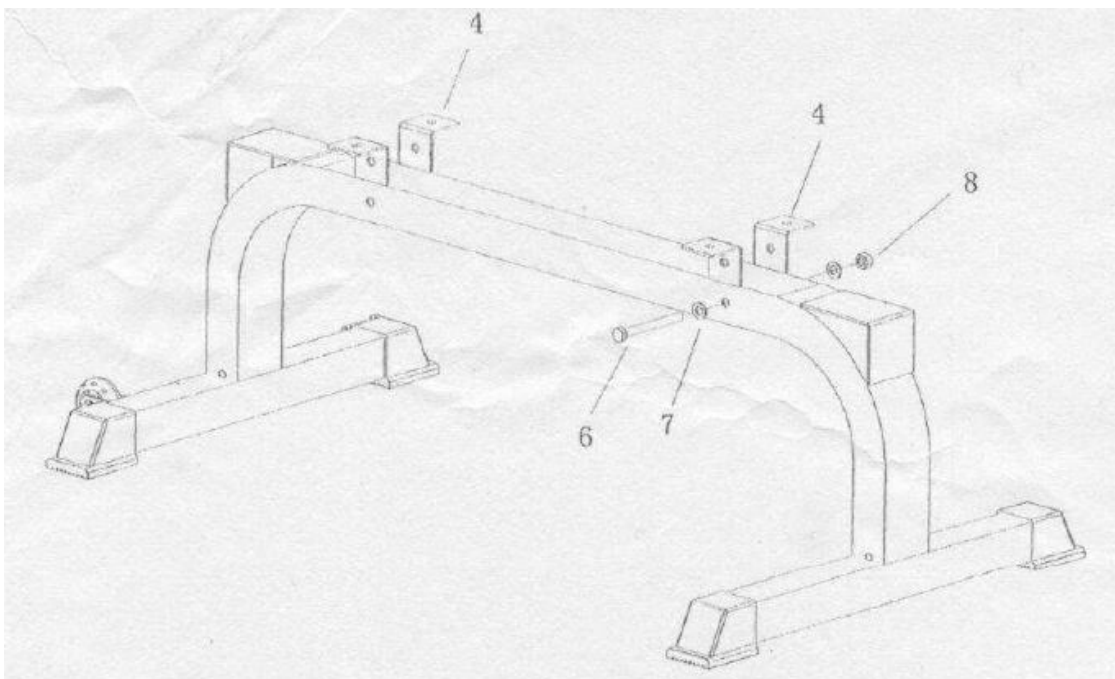

STEP 3

Attach back pad [5] to main frame using (4) hex bolts & washers [9, 10].

Note: Tighten all nuts & bolts with wrenches prior to use.

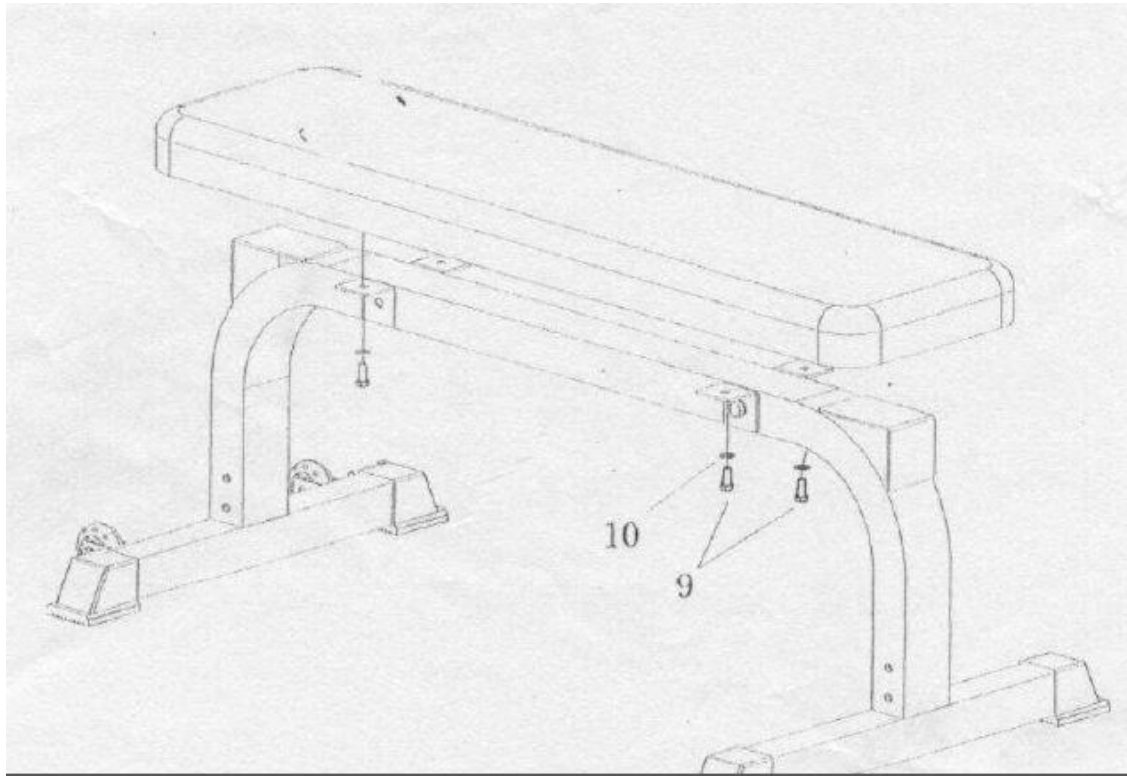

CARING FOR YOUR BENCH

MAKE YOUR INVESTMENT LAST

Cleaning

After each use, wipe your bench down with a clean, dry towel. If deeper cleaning is required, a damp towel and mild detergent should suffice. Avoid harsh chemical cleaning products, as they may damage the finish.

Re-tightening hardware

Periodically inspect the bench for signs of wear or loosening hardware. Make sure all nuts & bolts are tight. This bench is designed to support a good amount of weight and deliver reliable service over many years, but it will only do so when properly assembled and maintained.

CONTACT CFF WITH ANY QUESTIONS

WE WANT YOU HAPPY!

phone: (717) 207-7171

email: sales@cffit.com

We're here if you need us. (And we appreciate your feedback!)